



Palisades Charter High School Reconstruction Project

Community Meeting

August 11, 2025

Agenda

- I. Welcome & Meeting Logistics
 - Lorena Padilla-Melendez, Director, Community Relations, LAUSD
- II. Progress Update of Environmental Work
 - Anthony Espinoza, Environmental Health Manager, Environmental Programs, LAUSD
- III. Proposed Project
 - Scott Singletary, Deputy Director of Facilities Planning and Development, LAUSD
- IV. Design Progress
 - Jesse Miller, Education Leader Principal K-12, DLR Group
 - Jeffrey Zolan, Project Manager, DLR Group
 - Alenoush Aghajanians, Principal Design Leader, DLR Group

 - Questions, Comments & Community Engagement Next Steps

Zoom Webinar — Submit questions and/or comments



To ask a question or provide a comment, please use the “Q&A” icon and submit it at any time during the meeting.

OEHS Updates



Environmental Work Complete / Checklist

1. ☒ USACE Household Hazardous Waste Removal (Phase 1)
2. ☒ USACE Debris Removal (Phase 2)
 - Includes site assessment and removal of any asbestos, debris (i.e. concrete, metal, ash), and surface soils (top 3-6 inches)
3. ☒ LAUSD Debris Removal
4. ☒ LAUSD Contractor – Environmental Assessment of Soils
5. ☐ LAUSD Contractor – Comprehensive Environmental Assessment and Cleanup of Building Interiors
6. ☐ LAUSD Pre-occupancy Testing and Inspection



OEHS Updates

Materials Tested and Analyses

Soil

- Volatile Organic Compounds (VOCs)
- Total Petroleum Hydrocarbons
- Polycyclic Aromatic Hydrocarbons (PAHs)
- Title 22 Metals, including mercury
- Organochlorine Pesticides
- Polychlorinated Biphenyls (PCBs)
- Dioxins and Furans
- Asbestos

Air

- Asbestos
- Fire-related VOCs

Surfaces (via wipes)

- Title 22 metals, including mercury
- PAHs
- Dioxins and Furans



OEHS Updates

Safety Measures When Students Return

Continued Environmental Monitoring

LA Unified Know Your Air Network 2.0

- Enhanced air quality monitoring (PM2.5, PM10, NO2, and weather data) in real time with online public access
- 21 schools impacted by the fires or near reconstruction zones have received new, enhanced equipment. PM 10 sensors are scheduled to be added in the coming weeks.
- Five high-priority schools have been equipped with multiple monitoring locations. Will provide site-specific decision-making information during cleanup and reconstruction



Palisades Charter HS Campus Reconstruction Project

Board Approved June 3, 2025

\$266M –Bond Funds target to upgrade and expand charter school facilities
Reimbursement will be pursued through insurance and FEMA

Scope – replace facilities that were destroyed in the fire, including:

- General/specialty classrooms, support spaces, and athletic support buildings
 - **Update: portable buildings that remained post fire will now be removed due to extensive mitigation requirements**
- Infrastructure, landscape, track and field and other impacted facilities
- Both temporary and permanent facilities will be constructed to serve the student populations that were present prior to the fire.

New Construction – Program Overview

New Classroom Building

- 21 General Classrooms
- 1 Flexible Science Lab w/ workroom
- 1 Flexible Engineering Classroom
- 1 Media and Filmmaking Classroom
- 1 Multi-Media Computer Technology Classroom
- 1 Special Ed Type III Classroom w/support spaces
- 1 Special Ed Type I Classroom

- Collaboration Spaces, Workrooms, RSP, & Storage

- Administrative Spaces: 13 faculty/staff offices, 1 IEP Office, Conference Rooms, Clerical Areas, & Reception/Public Waiting

- Restrooms for students and staff

Palisades Academy

- 3 General Classrooms
- 3 faculty/staff offices

Athletic Field Areas

- Track and Field
- 2 x Athletic Support Spaces
- Ticket Booth
- Baseball Field

Anticipated Reconstruction Timeline

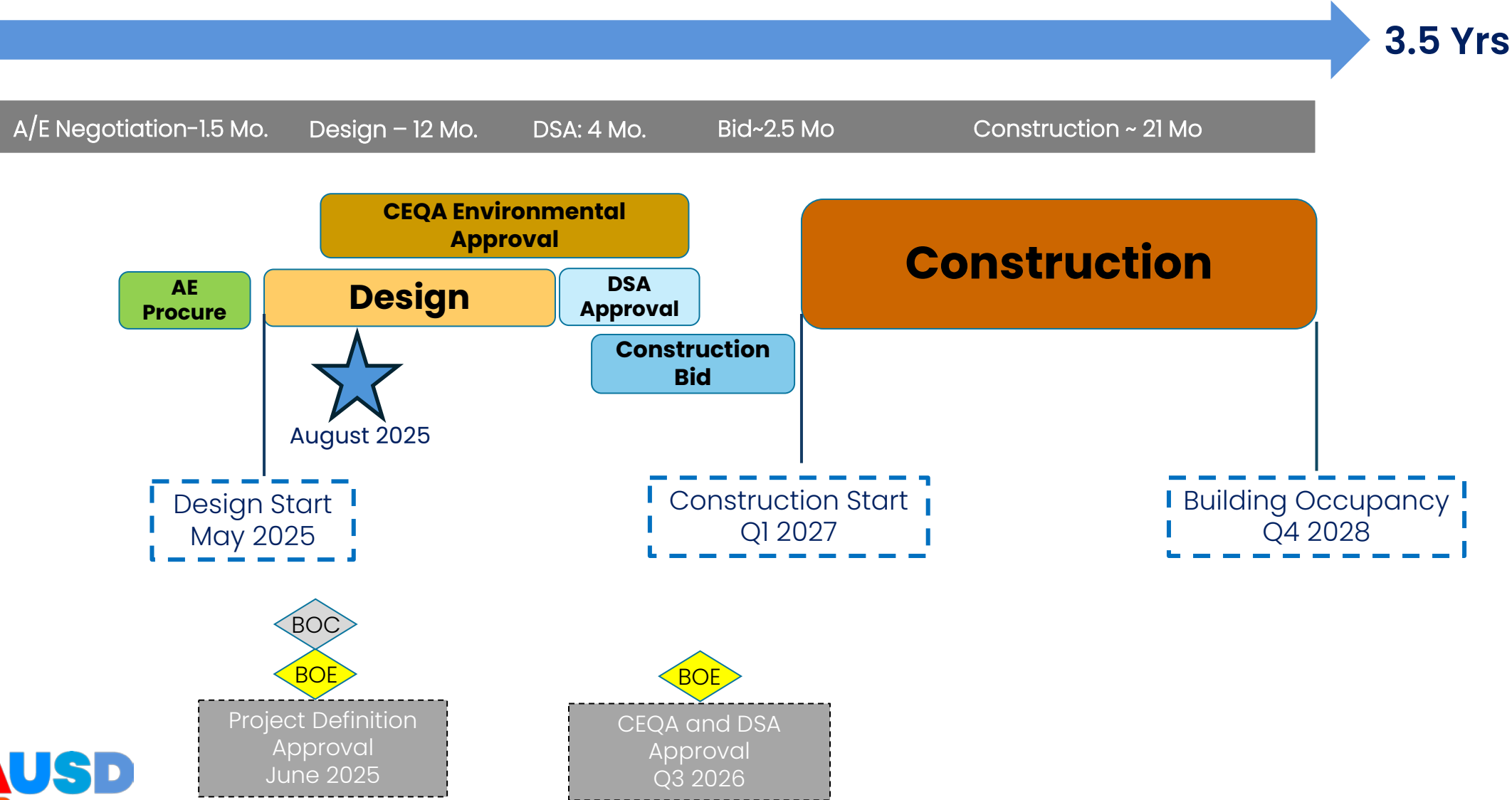

Your Team

 **DLR GROUP**

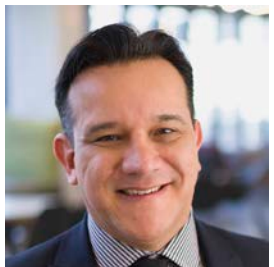
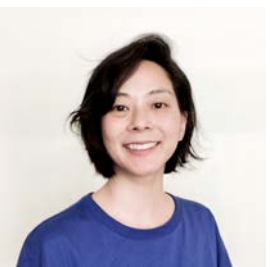

And many more.....

Consulting Engineers

P S O M A S

 **roshanian**
& associates

Kimley»Horn

 **MAROKO & SHWE, INC**
Consulting Mechanical Engineers

 **BRANDOW & JOHNSTON**
STRUCTURAL + CIVIL ENGINEERS
EST 1945

HLCM

 **PROTECTION DESIGN AND CONSULTING**

**Historic
Resources
Group**

Where Are We Going Together



The background image shows a two-story brick school building with a large circular emblem on its facade. In the foreground, there is a low concrete wall with the words "PALISADES HIGH SCHOOL" carved into it. To the right, a chain-link fence and a tall palm tree are visible under a clear sky.

Mission Statement

PCHS will empower our diverse student population to make positive contributions to the global community by dedicating our resources to ensure educational excellence, civic responsibility, and personal growth.



DLR's project goals/guiding principles.

Belonging

Foster social connection through layered indoor-outdoor gathering spaces

Embed identity through student expression, co-designed spaces, and cultural markers

Create zones of comfort, reflection, and collaboration for all learner types

Resilience

Design with fire-adaptive materials, passive systems, and flexible structures

Develop campus-wide emergency adaptability (safe zones, distributed infrastructure)

Celebrate the rebuild through spaces that mark recovery and community strength

Sustainability

Maximize daylighting, cross ventilation, and natural shading through form orientation

Use regenerative landscaping native to the local biome

Incorporate visible systems (solar, water reuse, carbon tracking) for student learning

The background image shows a modern school building with a brick facade and large glass windows. A sign on the building reads "INTERLACE". In the foreground, there is a low concrete wall with some plants. To the right, there is a chain-link fence and a sign that reads "PINE BLISS HIGH SCHOOL".

Design Concept

Interlace. Connect. Thrive.

Interlace — the spatial and programmatic strategy

Connect — to each other, the past, and the future

Thrive — not just survive; speaks to student success and community strength

Site Diagrams



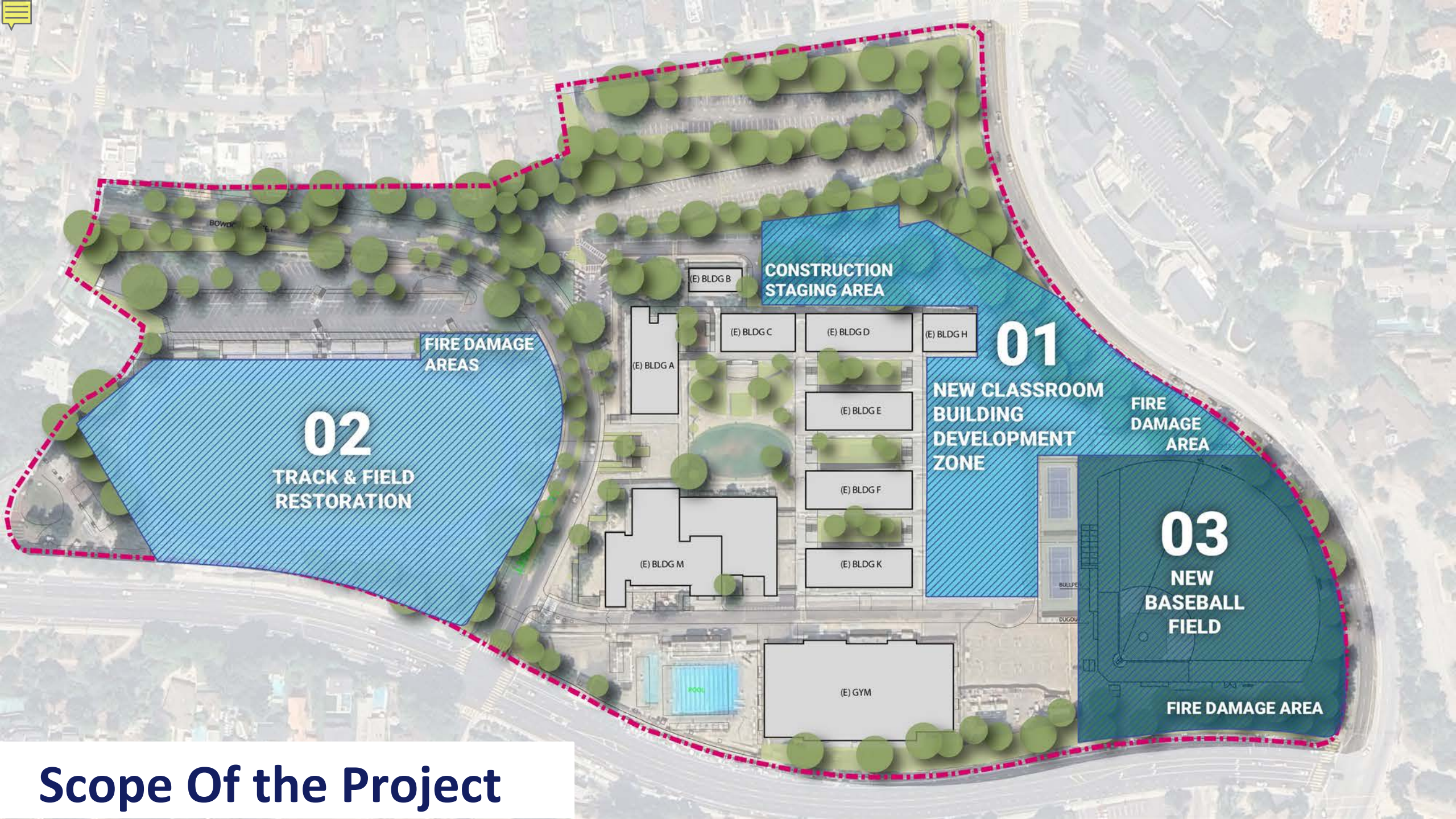

Scope Of the Project

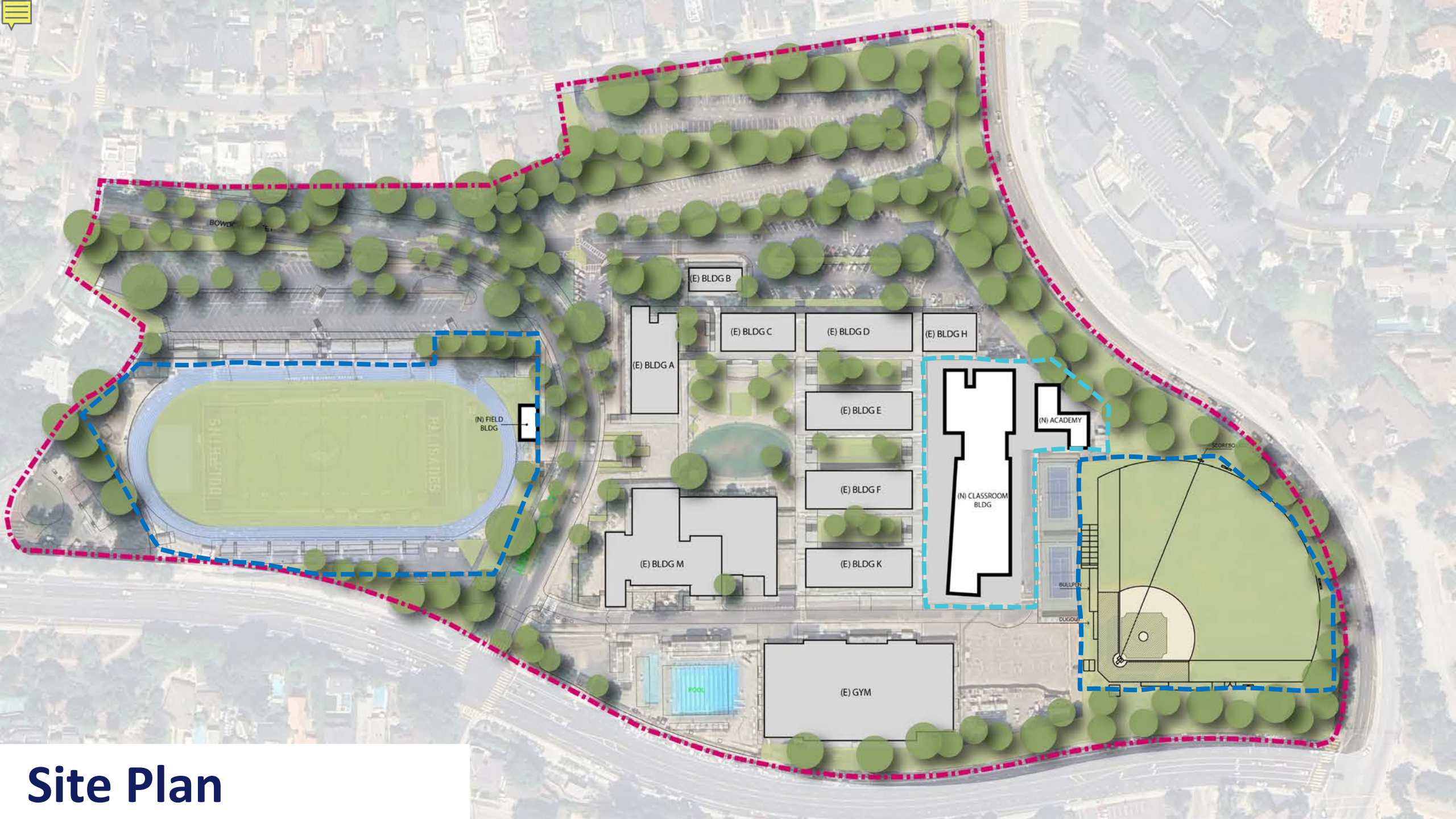

Site Plan

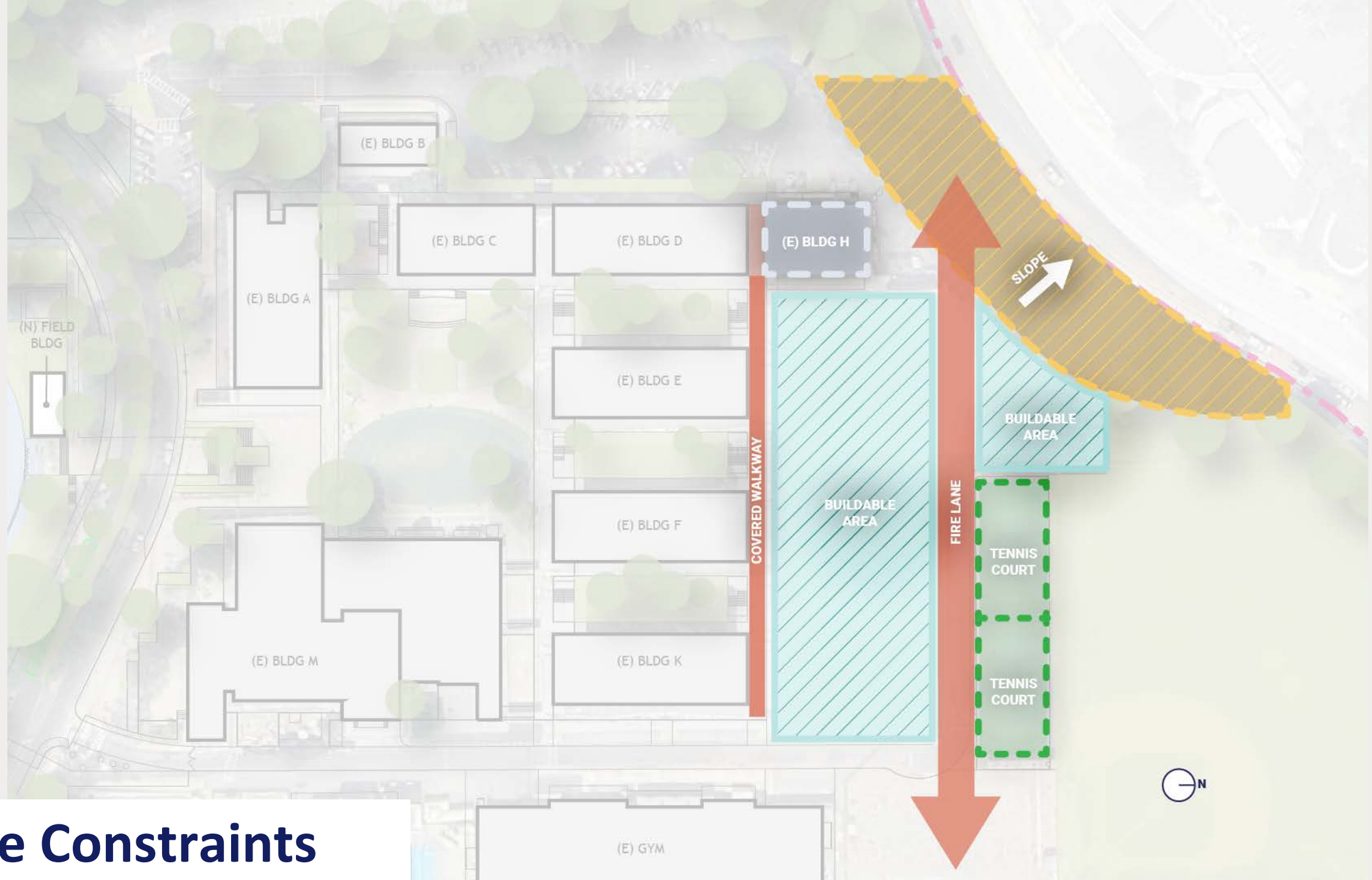

Site Constraints

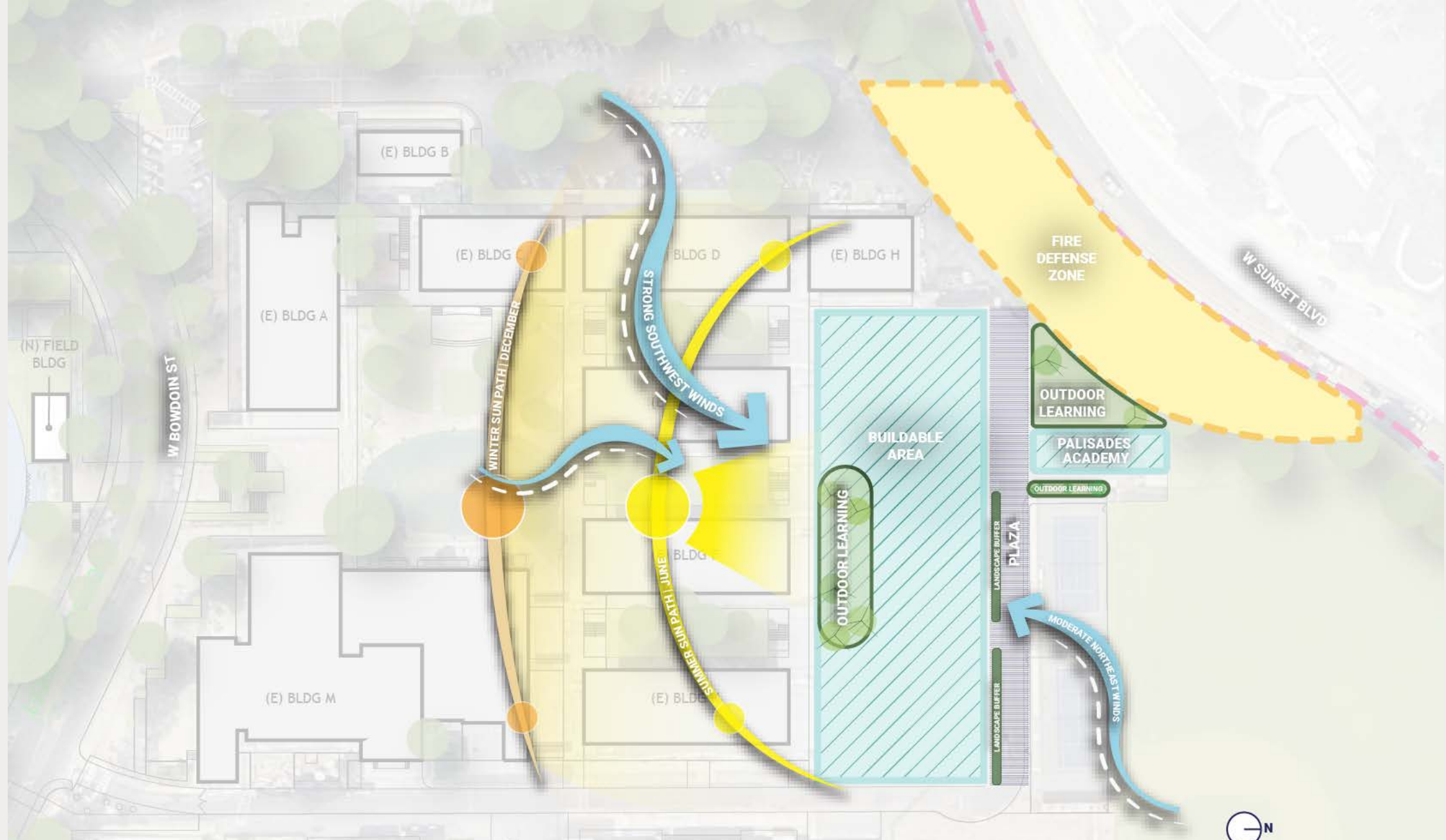

Greener. Safer. Smarter.

(E) GYM

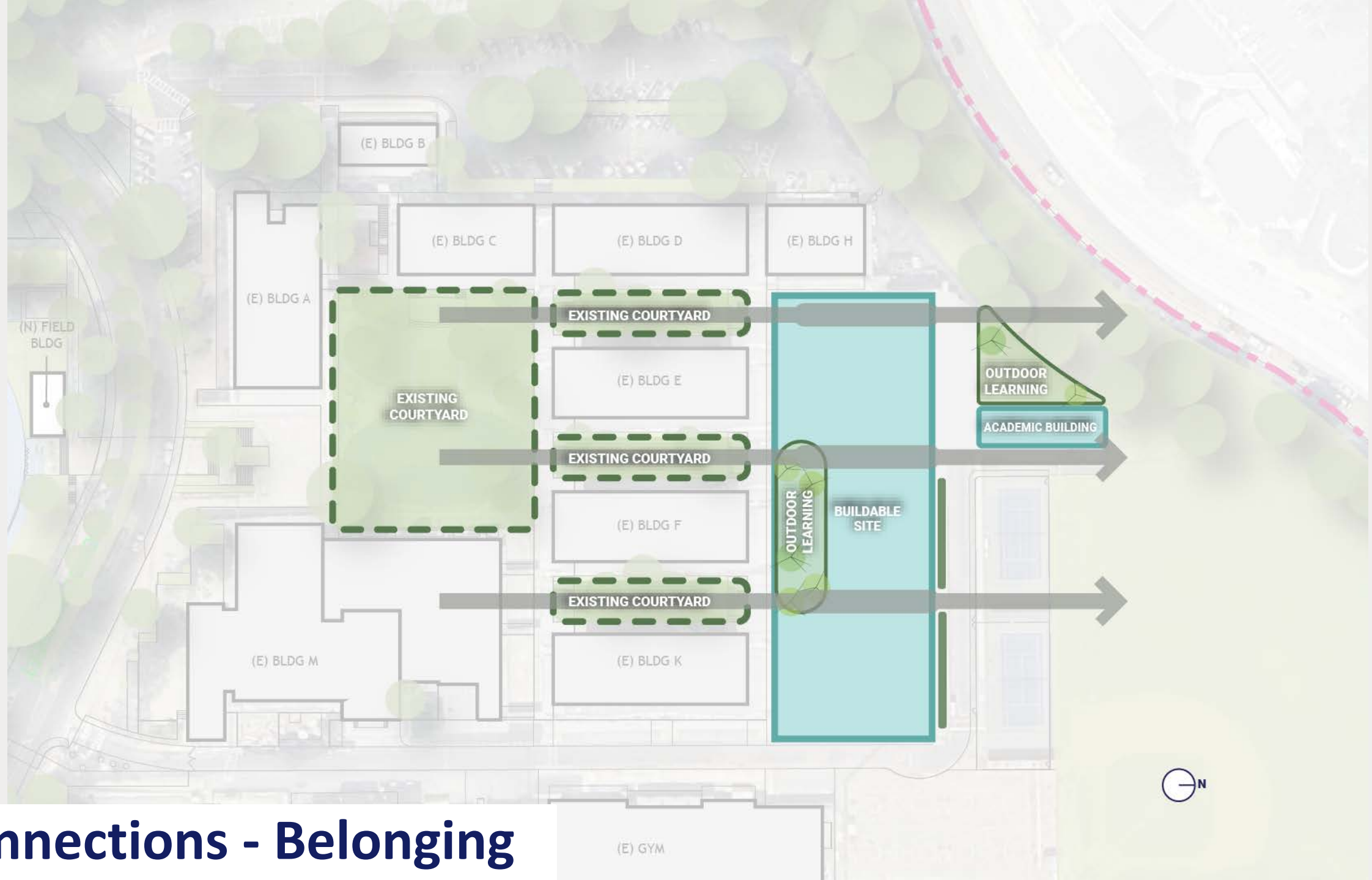

Connections - Belonging

—

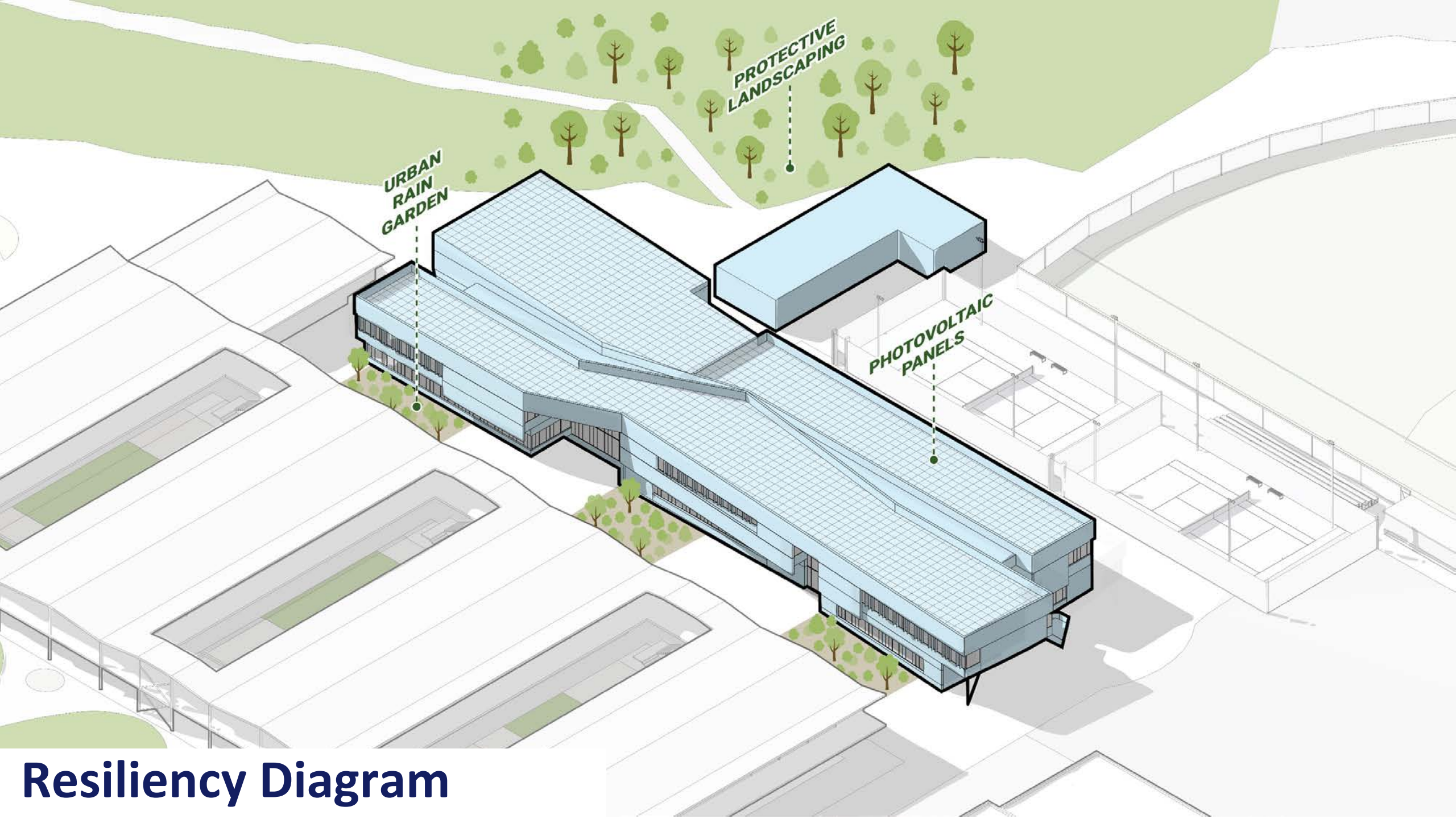

Resiliency Diagram

Space Types

Program

Palisades High School

- 21 General Classrooms
- 1 Flex Science Lab
- 3 Elective Specialized Classrooms
- 2 Special Ed Classrooms
- 1 Satellite Admin
- 2 Student Collaboration
- 2 Teacher Workroom

Pali Academy

- 3 General Classrooms
- Admin Offices
- Support Spaces

30 Total Classrooms

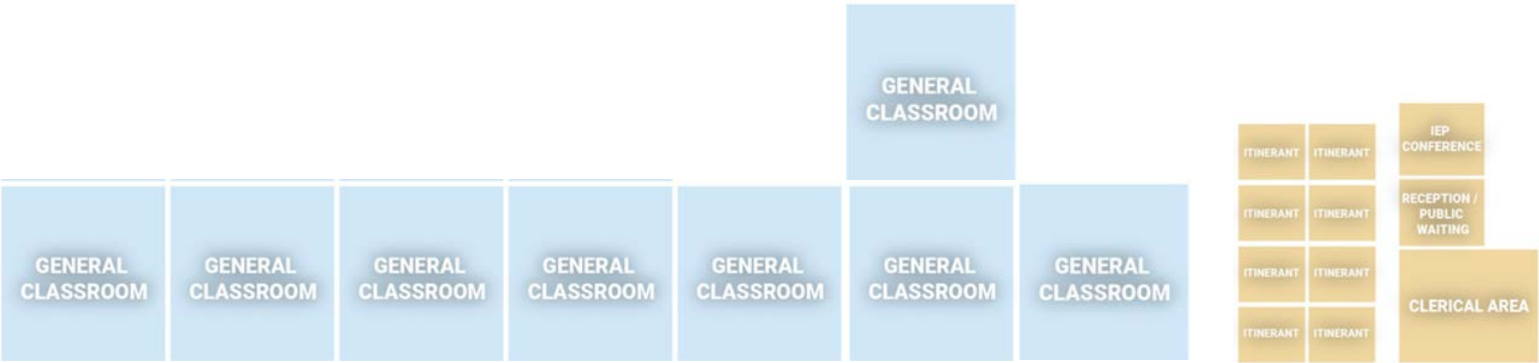

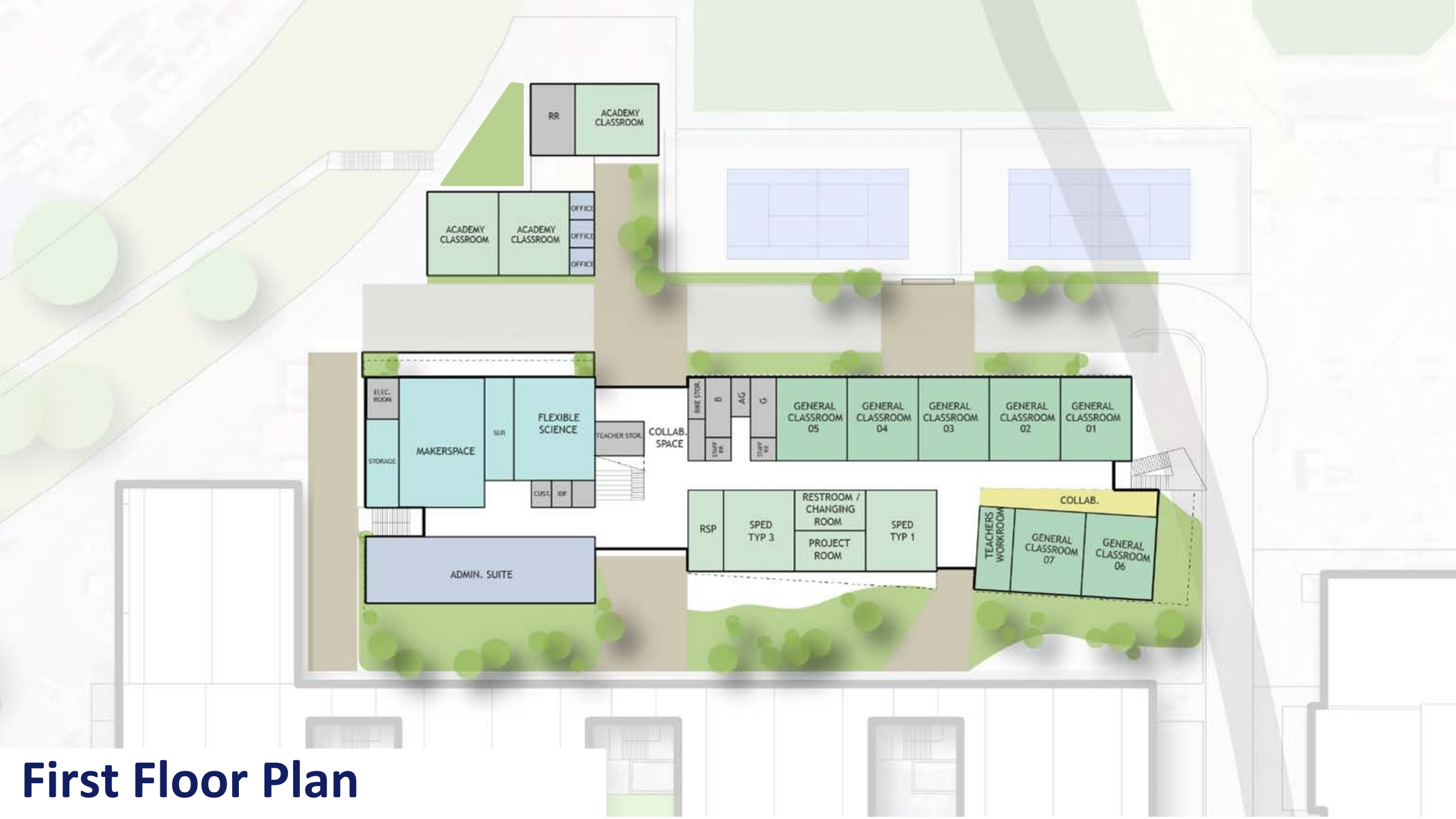

First Floor Plan



Second Floor Plan

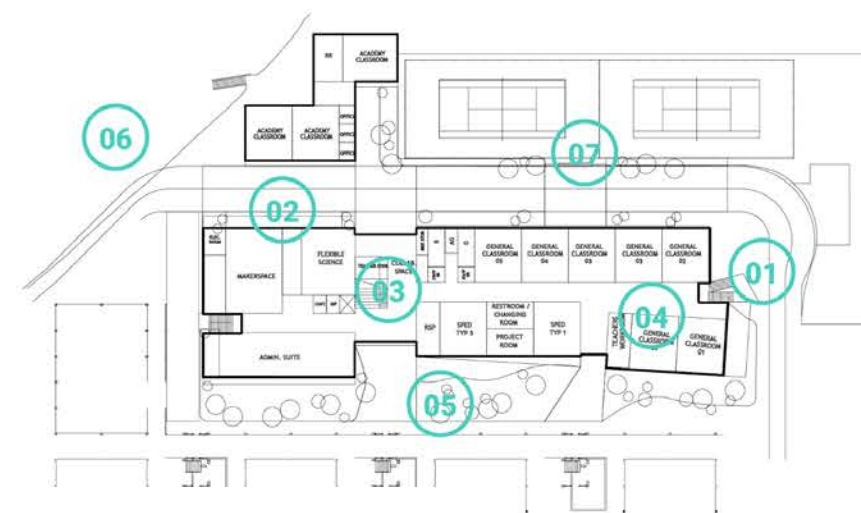
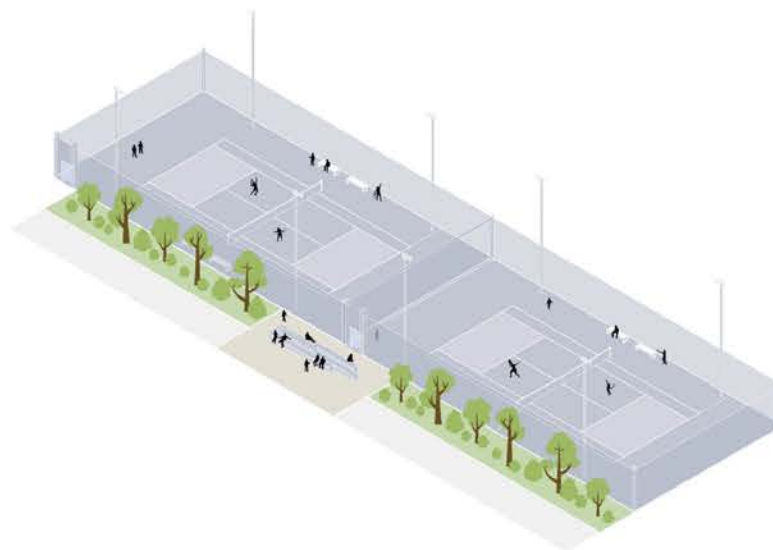
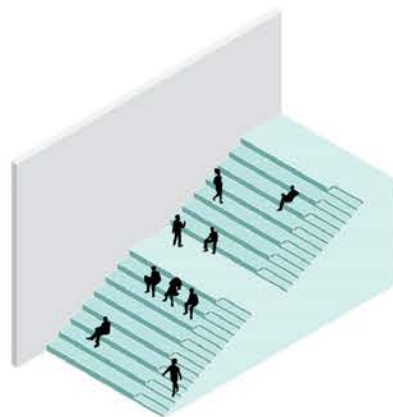



Design Inspiration For The New Buildings

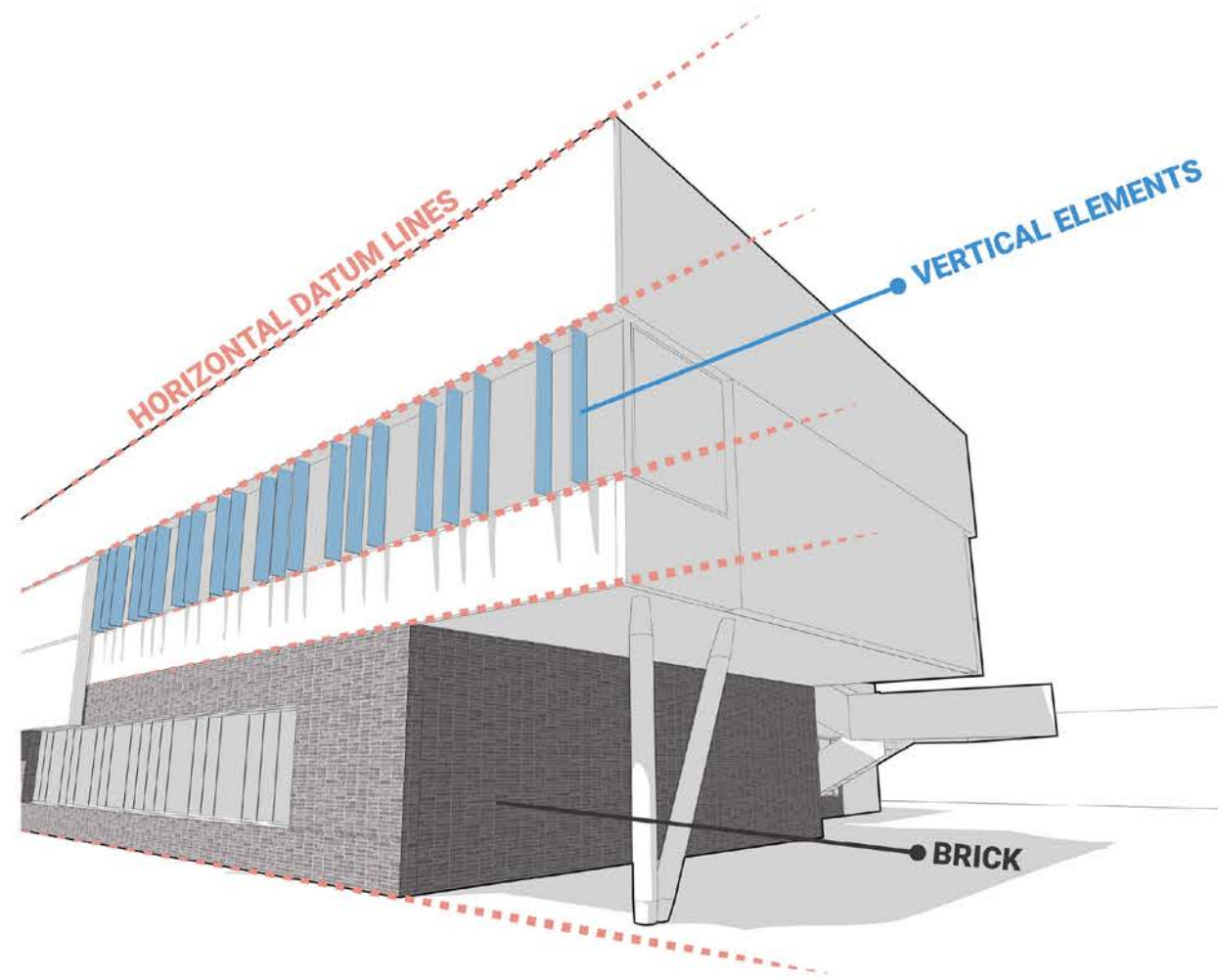
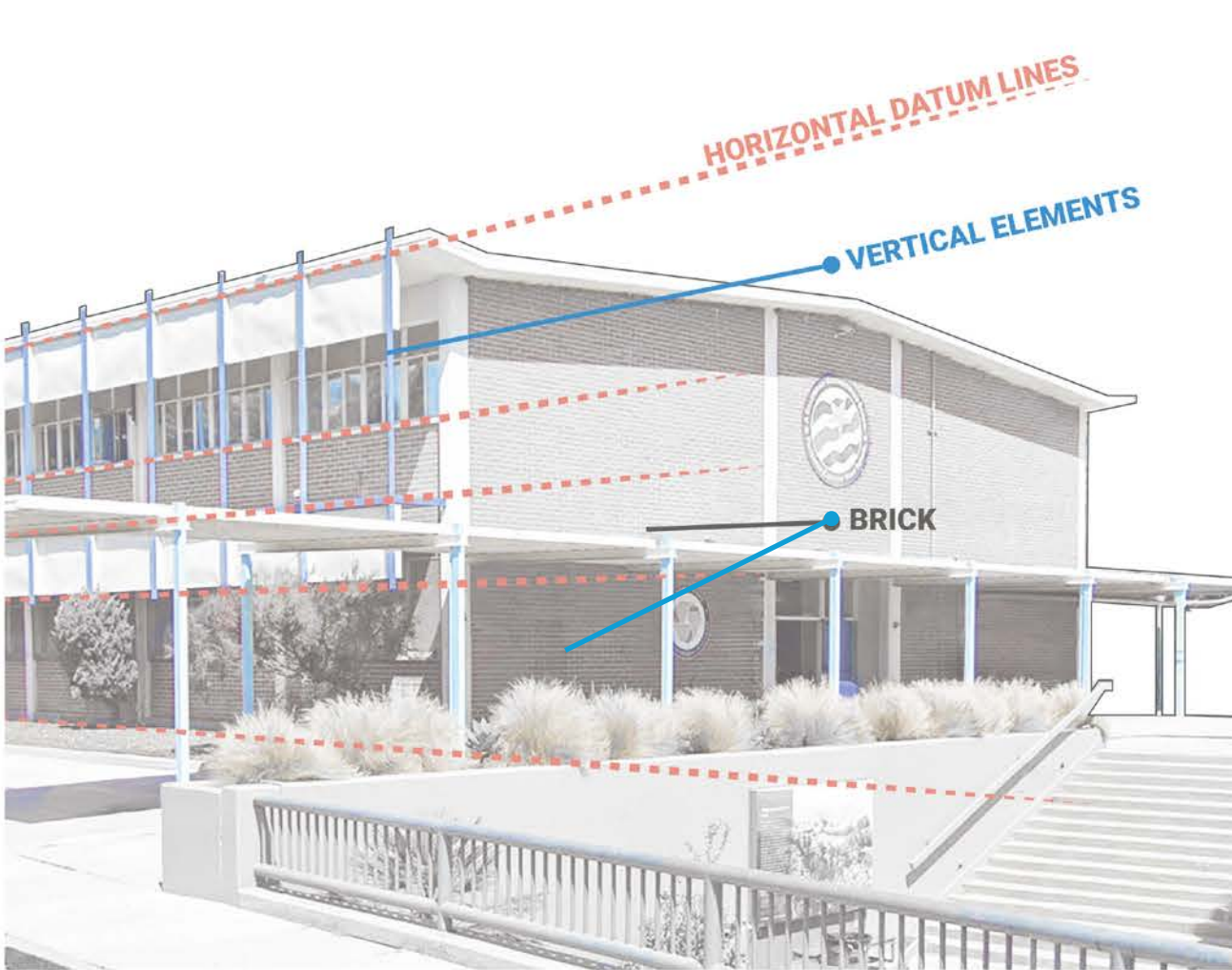

Getting Inspired From The Existing Buildings

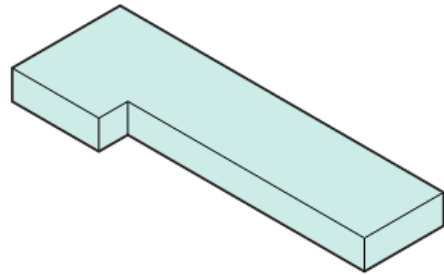

Base

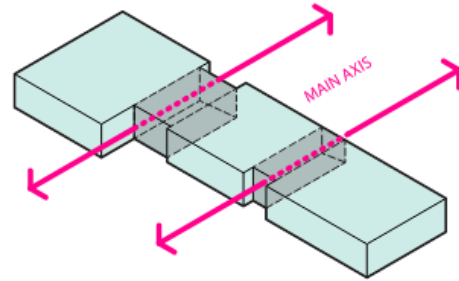

Connect to
Courtyard

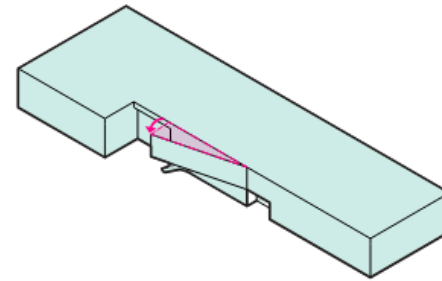

Pull Facade

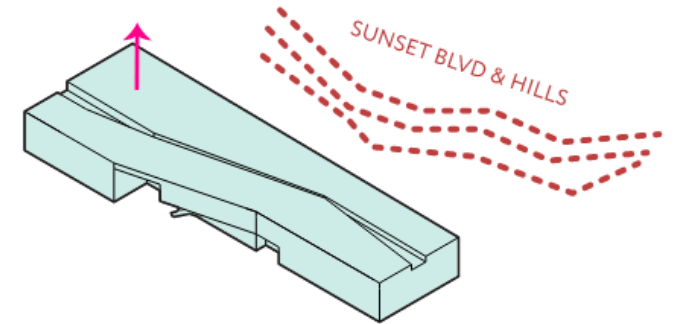

Contours Follow
Mountains

Forming The Massing











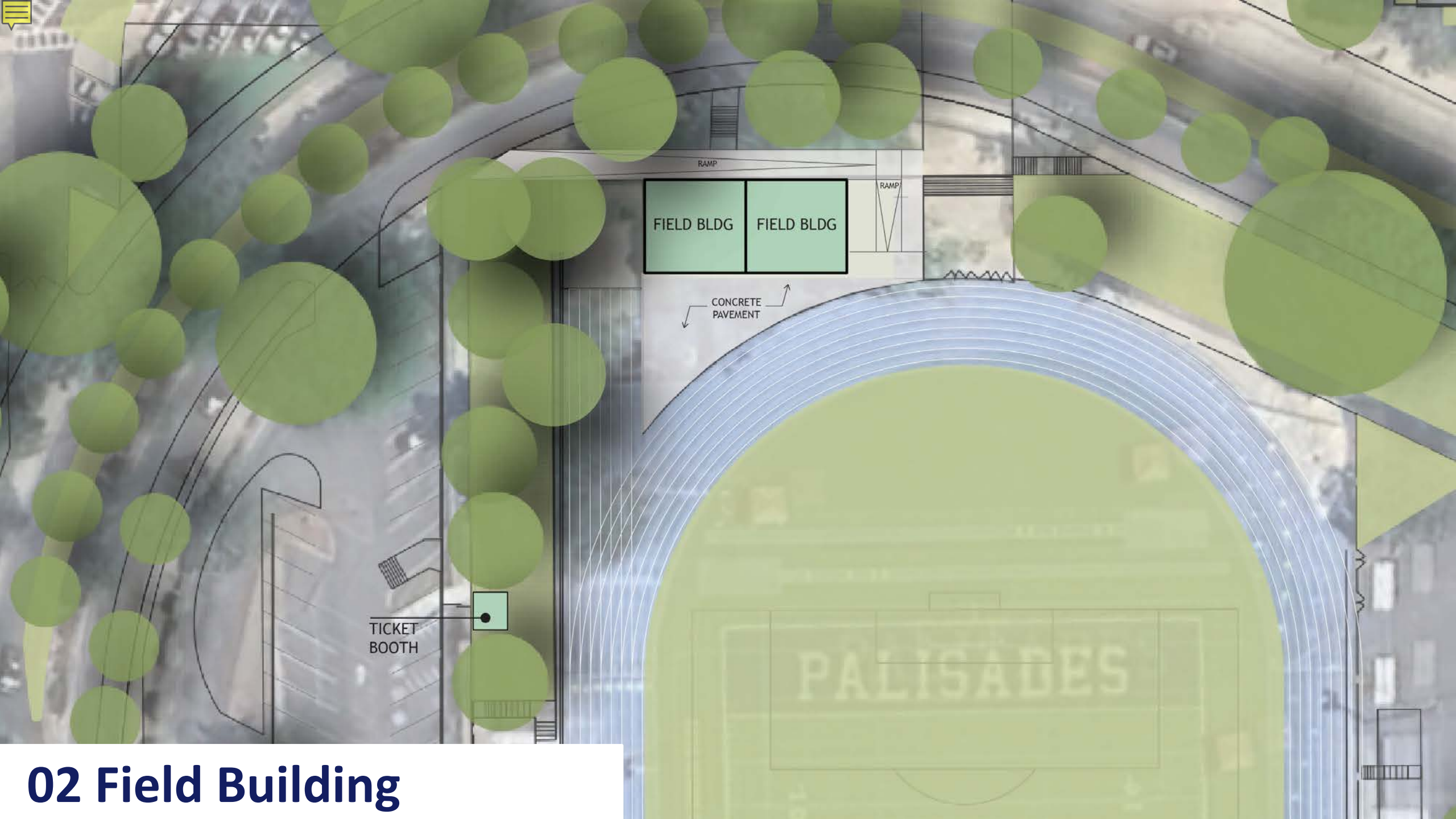

02 Field Building

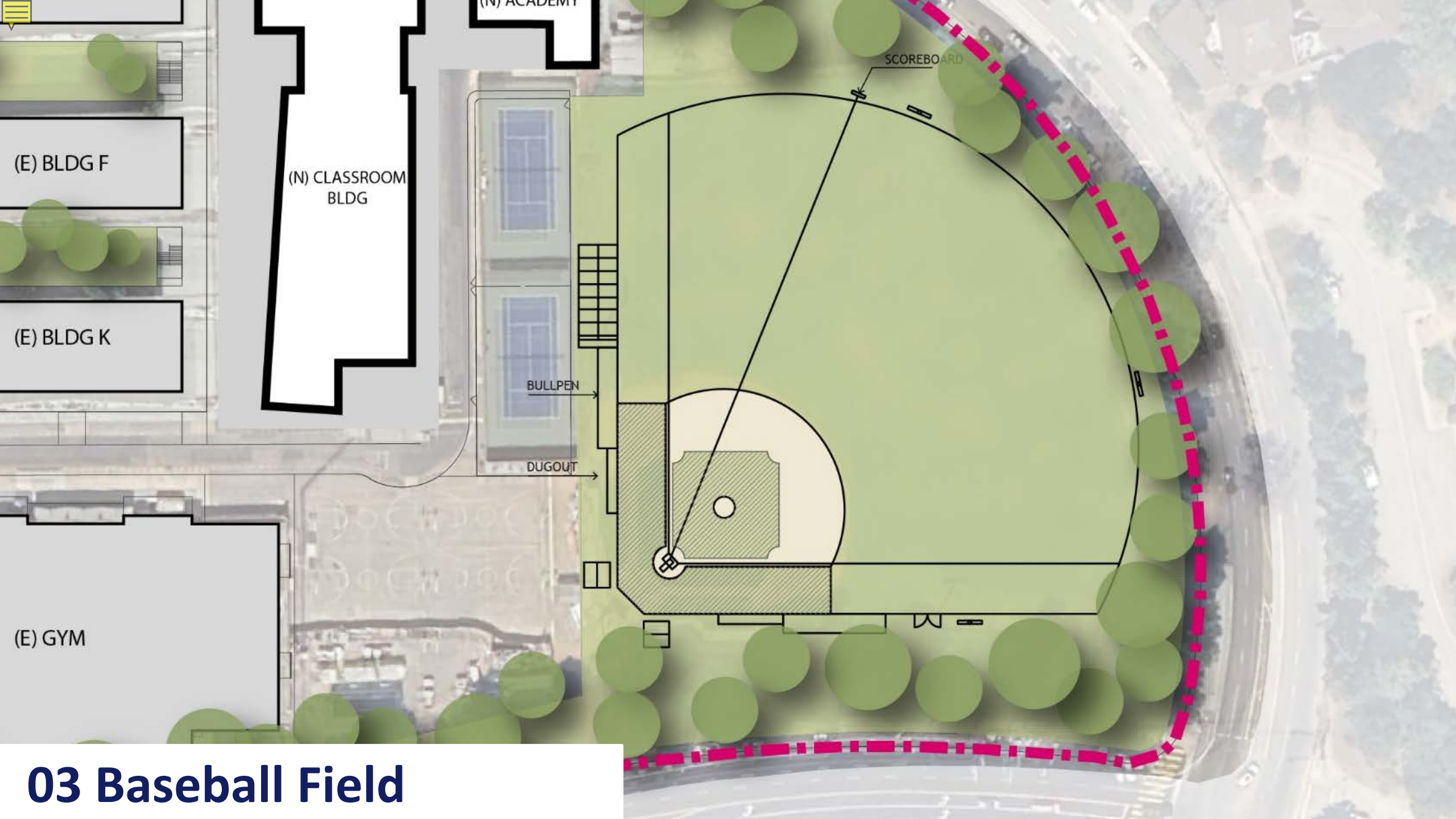

03 Baseball Field

FSD Community Relations Engagement Plan for the Design Process

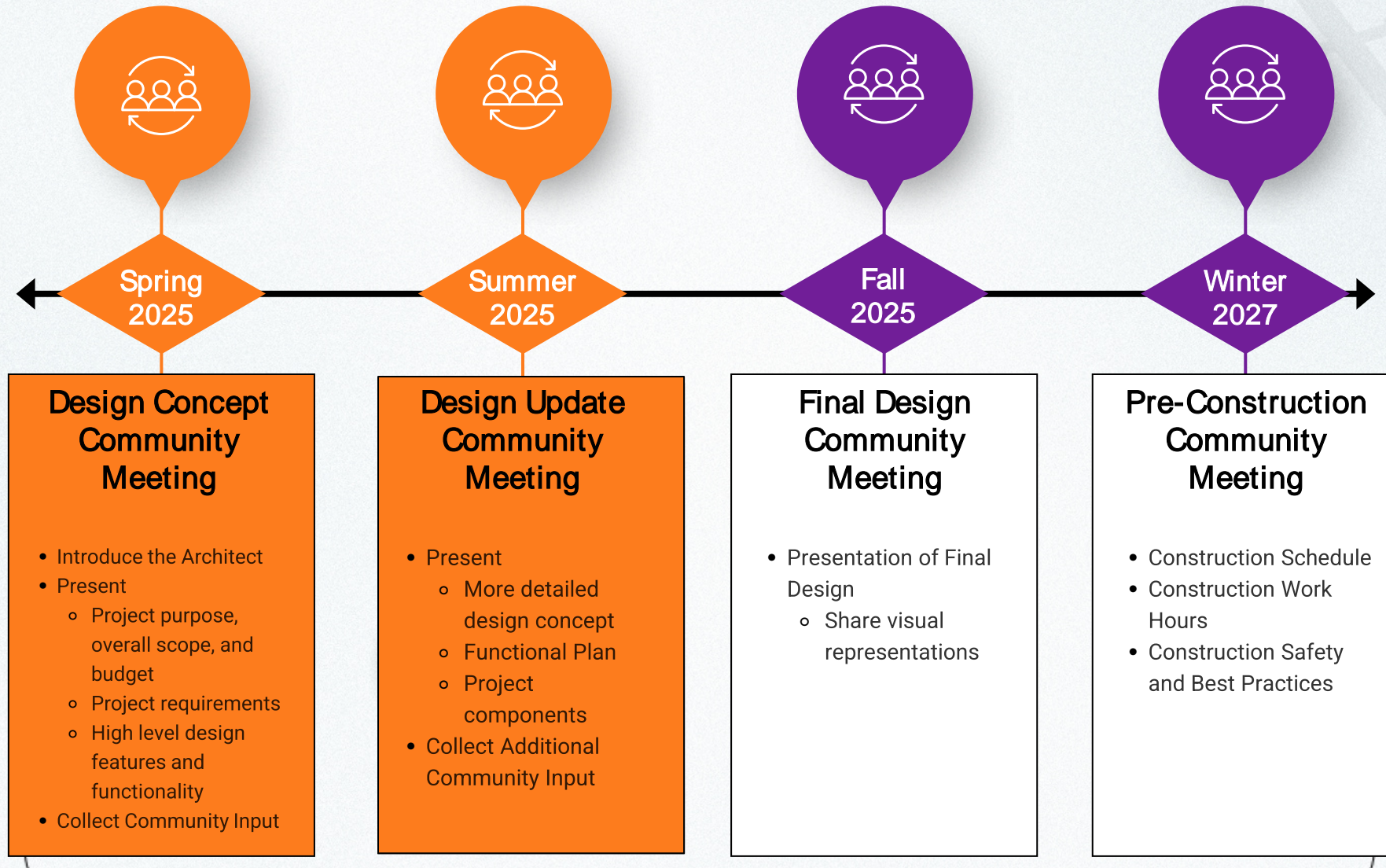

Stakeholder engagement will continue throughout the duration of the project.

Submit questions by
scanning the QR code.

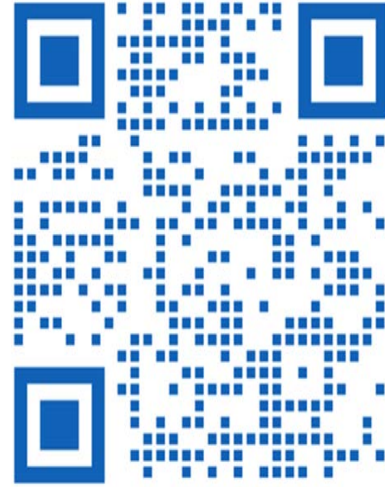

FSD Community Relations Department: 213-241-1340

community.relations@laschools.org

<https://www.lausd.org/facilities/community-relations>

For unrelated construction project questions or concerns,
please email Region West Operations at:

FireRecoveryWest@lausd.net